

TMH CEILING ANCHOR

Usage:

- fixing hangers for suspended ceilings
- fixing of perforated banding
- fixing of fireproof cabling

Advantages:

- Can be used in cracked and non-cracked concrete
- Fire resistance up to R120 - non-flammable fixing
- Quick and each assembly

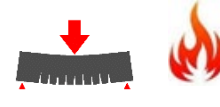

Multiple use for non-structural applications

Anchor material:

Anchor shaft made of ML08Al carbon steel, wedge made of 45 (C1045) steel. Galvanized anchor min. 5µm.

Substrate material:

Reinforced or unreinforced normal weight concrete of a strength class c20/25 at minimum to c 50/60 at maximum to EN 206.

Method of marking TMH nails		
Symbol	Nail diameter d [mm]	Nail length L[mm]
TMH06040	06	040
TMH06070	06	070

Installation Parameters

Installation Parameters			TMH040	TMH070
	Symbol	Unit		
Anchor Diameter	d	[mm]	6	
Anchor Length	L	[mm]	40	70
Drill Hole Diameter in Base Material	d _o	[mm]	6	
Fixture Clearance Hole Diameter	d _f	[mm]	6.5	
Effective Anchorage Depth	h _{ef}	[mm]	30	
Minimum Hole Depth	h ₁	[mm]	40	
Minimum Base Material Thickness	h _{min}	[mm]	80	
Maximum Fixture Thickness	t _{fix}	[mm]	5	35
Design Spacing	S	[mm]	200	
Design Edge Distance	C	[mm]	150	

Load Data

All Load Directions	TMH040/TMH070		
	Symbol	Unit	Value
Characteristic Resistance	F _{Rk} ⁰	[Kn]	3.0
Design Resistance	F _{Rd}	[Kn]	1.2
Recommended Resistance	F _{Rec}	[Kn]	0.85
Shear Load with Lever Arm			
Characteristic Bending Moment	M _{Rk,s} ⁰	[Nm]	6.6
Design Bending Moment	M _{Rd}	[Nm]	3.8
Recommended Bending Moment	M _{Rec}	[Nm]	2.7

Fire Loads

All Load Directions		TMH040/TMH070	
Characteristic Resistance $F_{Rk,fi}^{(1)}$	R30	[Kn]	0.75
	R60	[Kn]	0.75
	R90	[Kn]	0.75
	R120	[Kn]	0.6
Spacing	S_{min}	[mm]	150
Edge Distance	C_{min}	[mm]	200

The design method covers anchors with a fire attack from one side only. In case of fire attack from more than one side, the edge distance shall be $\geq 300mm$

¹⁾ In the absence of national regulations a partial safety factor of 1.00 is recommended

TMH metal nail-in assembly diagram:

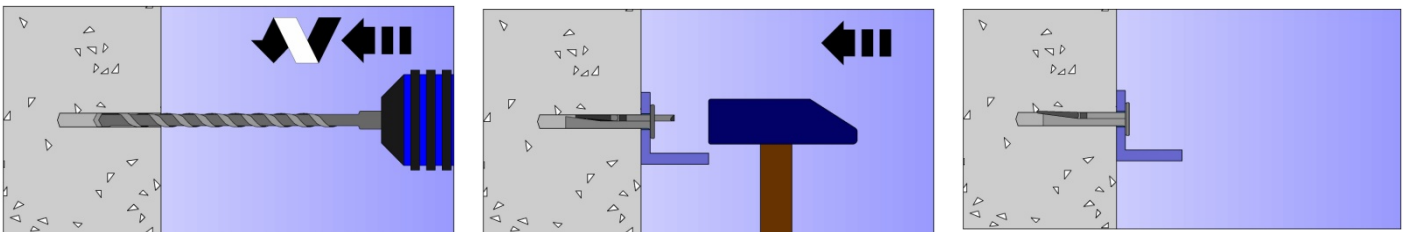

Zinc Plated anchors are for internal use only.