



TRUTEKTM
CONSTRUCTION FASTENING SYSTEMS

WHY Use our **Concrete Anchor?**



Save
MONEY

Save
TIME

WHY?

Concrete Anchor

- Increased loading achieved for equivalent expansion anchors
- Can fix into Crack and Non-Crack concrete
- Possible to use the same anchor 3 to 4 times, useful in temporary installations
- Fully adjustable – can be taken out after installation, fixture adjusted and anchor re-installed with no loss to loadings.
- No need for hammering causing no damage to anchor.
- Perfect flush finish with countersunk version



acts as a multiple undercut anchor

Heavy Duty Loadings Achieved



No expansion/No Stress

No expansions stress with mechanical interlock between base material and anchor.

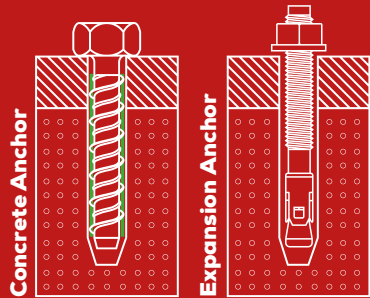

Concrete Anchor

Expansion Anchor

Fixes close to edge

Ideal for close to edge fixing where traditional expansion anchors may cause concrete failure due to base material stress.

Anchor can be totally removed and replaced if necessary.



Hollow Substrate, No Problem!

Anchor fixes along the complete length or the product which also enables fixing through hollow sections. Fixing into hollow materials without the need for Nylon sleeves or Resins



Less Drilling, More Holes

Uses smaller drill bits than the traditional expansion anchors.

No need to clean hole after drilling.

M10 Throughbolt uses a 10mm SDS Plus Drill Bit



M10 Concrete Bolt uses a 8mm SDS Plus Drill Bit

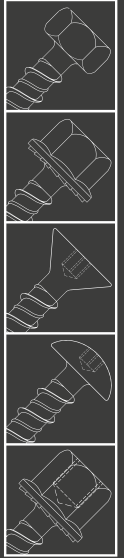

Through Fixing, No Pre-Drilling!

No marking out required, you can fix straight through the fixture into base material.

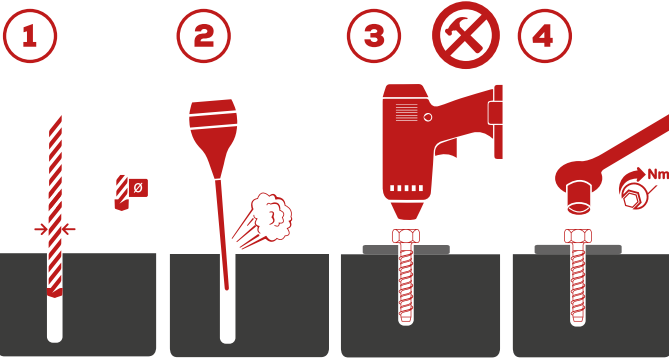

Variety of Base Materials

Works in many base materials such as Concrete, Brick, Wood, Marble, Block, Stone and more.

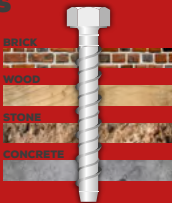

Save time

Sets immediately unlike resin products, also used for close to the edge applications, that require curing time.



TRADE focus

Trutek's ETA approved Concrete bolt can be used for various tunnel applications.

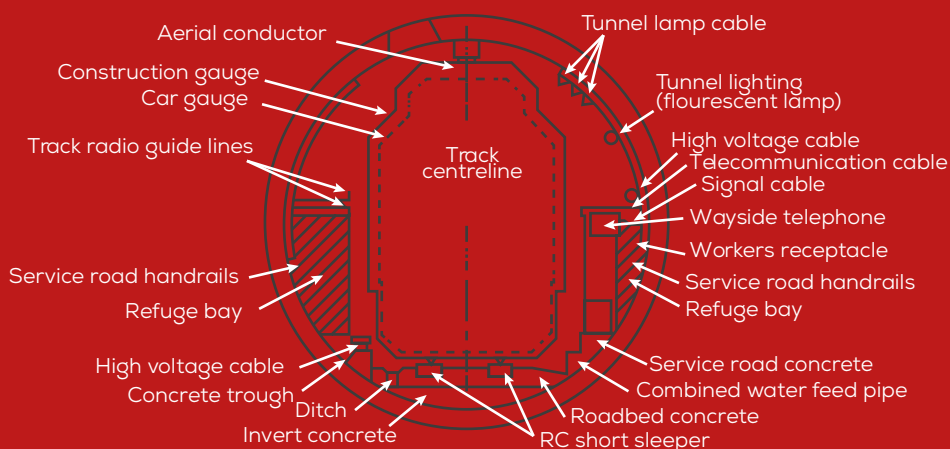

Other Applications:

- Tilt wall bracing
- Railing, Balustrades
- Racking
- Ventilation and air conditioning
- Safety Barriers
- Cable trays
- Heavy machinery for manufacturing

